



GENERAL CHARACTERISTICS

Structure	Aluminum
Classification	USCG Subchapter L/T ABS/DNV optional
Flag	USA

DIMENSIONS

Length O.A.	69 ft (21.01 m)
Length Hull	62.3 ft (19.0m)
Beam O.A.	24 ft (7.30 m)
Depth	8.86 ft (2.70 m)
Draft (max)	4.6 ft (1.401 m)
Displacement (Lightship)	45.2 (46 tonnes)

CAPACITIES

Fuel oil	1981 USG (7,500 L)
Fresh water	103 USG (1,000 L)
Black water	103 USG (1,000 L)
Free workdeck area	689 ft ² (64 m ²)
Max deck load	0.13 tons/ft ² (1.25 t/m ²)
Deck cargo	12 tons fwd, 3 tons aft (15 tonnes)
Crew	< 3 persons
Passengers	< 12 persons

PERFORMANCE

Speed (max)	30.0 knots (550 litres/hr)
Speed (high)	27.5 knots (500 litres/hr)
Speed (low)	25.0 knots (430 litres/hr)

PROPULSION SYSTEM

Main engines	2 x MAN V12-1400
Total power	2 x 1029 kW (2 x 1400 hp)
Gearbox	2 x ZF3050
Propulsion	2 x Hamilton HM571

ELECTRICAL EQUIPMENT

Network	24V DC, 208V 60 Hz AC
Generator set	1 x 17.5 kW

DECK LAY-OUT

Anchor equipment	1 X Fortress FX-125 w/ chain & line
Bow fendering	RG Seasight Rubber
Secondary access	Osbit MaXcess / TDD (Tube Docking Device) / VGRIP (optional)
Deck crane	Palfinger PK6500M (optional)
Mob recovery system	Ladder w/ Ship Mounted Davit

LIFE SAVING EQUIPMENT

USCG Compliant

ACCOMMODATIONS

Accommodation	12 x Saloon Seats, 2 x Crew Cabins (optional) Galley/Mess Area, 1 x Heads, 3 x Bridge Seats
Noise levels	<62 dba

21M WIND FARM SERVICE VESSEL

Crew Transfer Vessel

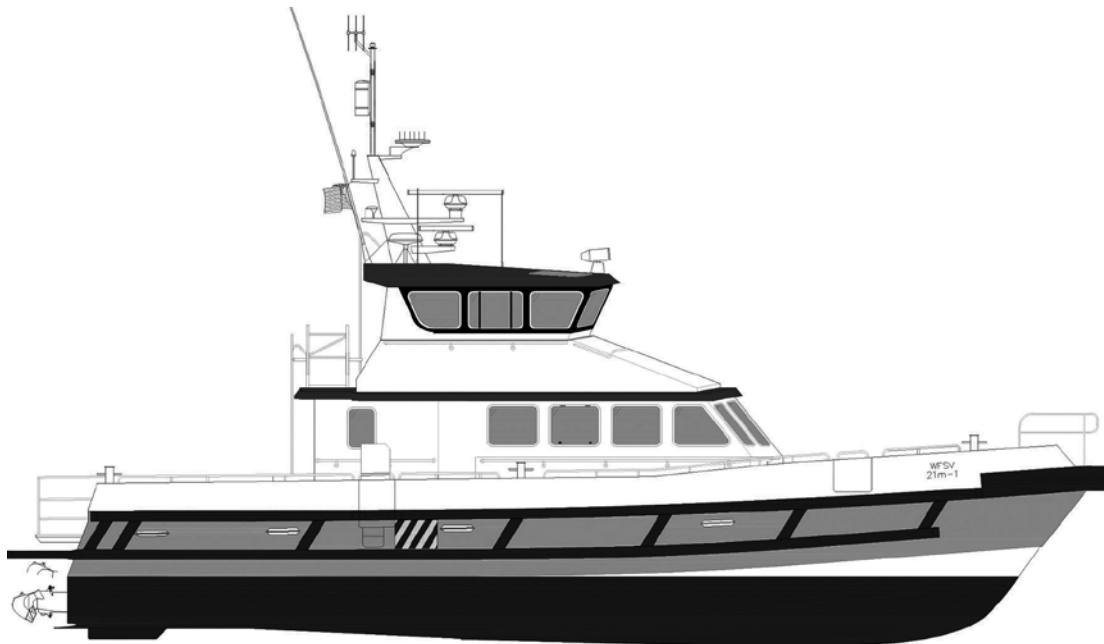

ELEVATION

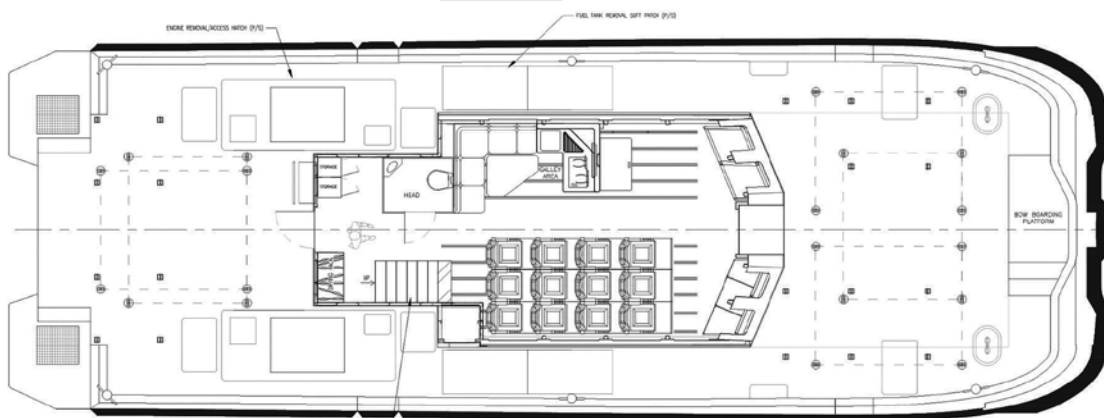

MAIN DECK PLAN

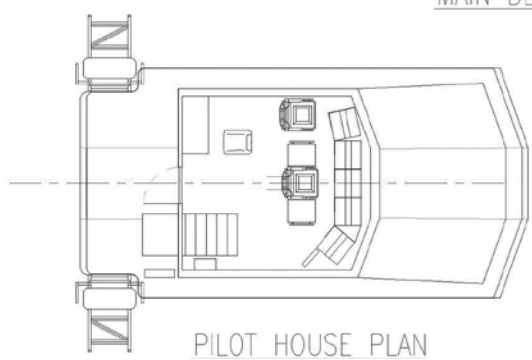

PILOT HOUSE PLAN



Under License with South Boats IOW



461 WATER STREET, PO BOX 368
WARREN, RHODE ISLAND, 02885

T 401.245.8300 F 401.245.8303 E info@blountboats.com W blountboats.com